

Instruction of Spiolto Respimat

- Generic Name: Tiotropium and Olodaterol
- Indication: Maintenance treatment of patients with Chronic Obstructive Pulmonary Disease (including chronic bronchitis and emphysema).
- Dosing: Inhale 2 puffs once daily from the RESPIMAT inhaler at the same time of the day.

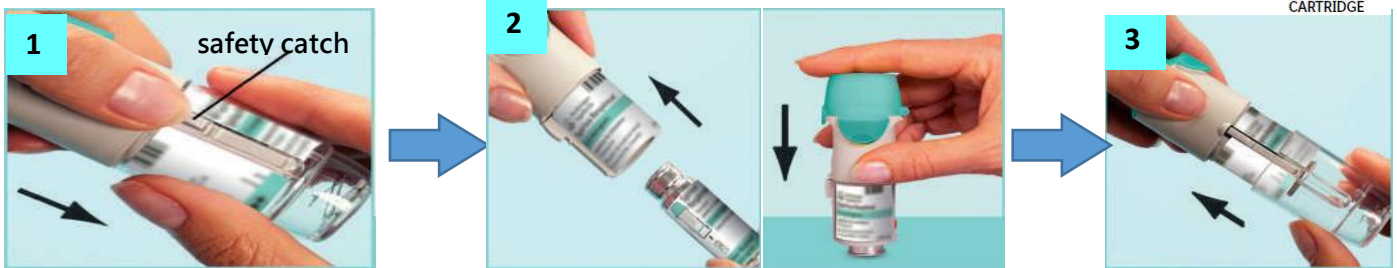

Setting cartridge (before first-use)



Keep the cap closed. Press the safety catch while firmly pulling off the clear base with your other hand.

Insert the narrow end of the cartridge into the inhaler.

Put the clear base back into place until it clicks.

Do not remove the clear base or the cartridge after it has been put together.

Prepare for first-use



Keep the cap closed. Turn the clear base in the direction of the arrows on the label until it clicks (half a turn).

Open the cap until it snaps fully open.

Point the inhaler toward the ground. Press the dose-release button.

First-time use: After a mist is seen, repeat steps 4 to 6 three times.

Daily use after first-use

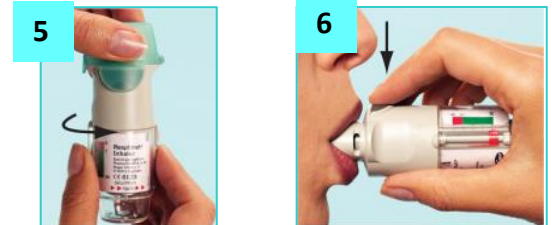

Keep the cap closed. Turn the clear base in the direction of the arrows until it clicks (half a turn).

Breathe out completely. With the inhaler in your mouth, without covering the air vents, press the dose-release button and breathe in deeply. Hold your breath for 5~10 seconds.

Repeat the steps for a total dose of 2 puffs.

When to get a new Spiolto Respimat



Empty

Full

When the dose indicator enters the red area of the scale you need to get a new prescription; there is approximately medication for 7 days left (14 puffs).

Once the dose indicator reaches the end of the red scale, your Spiolto Respimat locks automatically – no more doses can be released.

